

WASHBURN COUNTY HIGHWAY DEPARTMENT

Frank Scalzo, Commissioner

1600 County Highway H
SPOONER, WISCONSIN 54801
(715) 635-4480 Fax (715) 635-4485

Christopher Thompson, Chairperson Hank Graber, Vice Chair
Romaine Quinn Sandy Johnson Tim Kessler

July 19, 2018

NOTIFICATION OF ROAD CLOSURE

Starting Monday, July 23, 2018 the Washburn County Highway Department will be reconstructing CTH F in the Township of Chicog. Our main focus is the intersection of Bramer Road. This is a dangerous intersection which we will be relocating to the east. The road will be closed to thru traffic from Lodge Road to Christensen Road for most of the week. Please plan an alternative route

Thank you for your cooperation and I apologize for any inconvenience. Please call our office at 715-635-4480 with any concerns.

Frank Scalzo / Washburn County Highway Commissioner

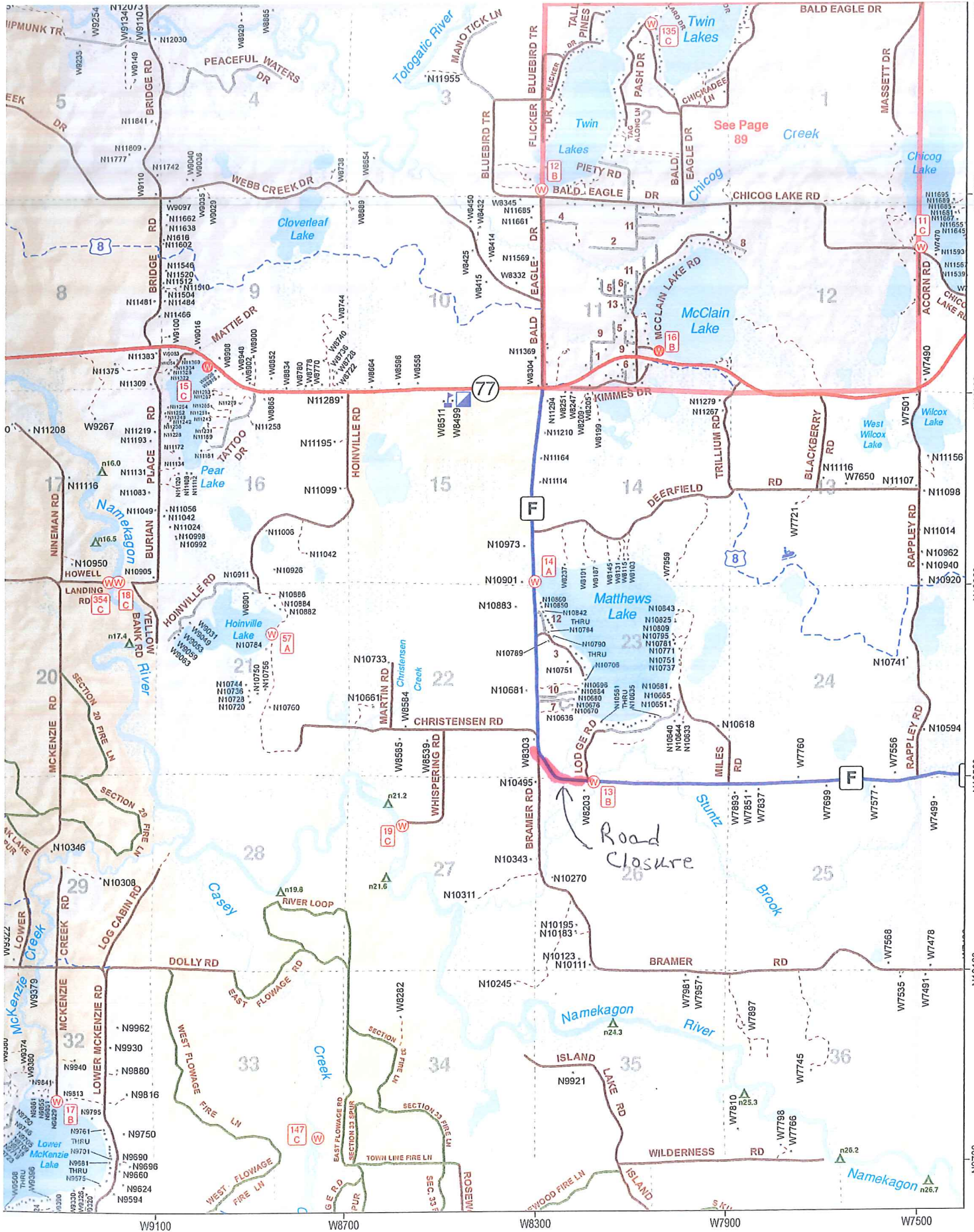

See Page 63

Numbered
Street
Index

- | | |
|----------------|------------------|
| 1. AVON AV | 5. ELA AV |
| 2. BENTON AV | 6. FREEMONT AV |
| 3. BYRKIT RD | 7. MINNESOTA DR |
| 4. CARDINAL RD | 8. REDPOLL RD |
| | 9. VERNON AV |
| | 10. WARDENS DR |
| | 11. WAUKESHA AV |
| | 12. WISCONSIN DR |

See Page 91