

Public Involvement Meeting Handout

**US 63
Cumberland - Spooner
Yellow River Bridge B-65-0014
Washburn County**

Project ID: 1550-04-14/84



**5 to 6 p.m.
Feb. 5, 2025
Spooner City Hall**

Project Purpose and Need

Purpose:

The purpose of this project is to rehabilitate the deteriorating structure (B-65-0014), which carries US 63 over the Yellow River.

Need:

The project needs which support the project purpose include the following components:

- Structural deficiencies
- Not meeting current roadway design standards

Structural Deterioration:

Built in 1975, the Yellow River Bridge is a single-span concrete girder structure supported by concrete abutments. It is 73.7 feet long, and the clear roadway width between concrete curbs is 48 feet. The structure last received a concrete deck overlay and miscellaneous repairs in 2006.

Based on the most recent inspections, the concrete deck has potholes and asphaltic patching throughout. Deck evaluations indicate 15% of the wearing surface is deteriorated or delaminated. Additionally, concrete surfaces on the deck, abutments and parapet are delaminated and spalling with exposed rebar.

Nonconforming Standards:

The guardrail on the approaches was installed in 2004, does not meet current standards and is past its service life.

Project Details

WisDOT is proposing to rehabilitate the deteriorated structure. Work would include:

- Overlaying the bridge deck with concrete
- Making concrete surface repairs to bridge abutments and parapet
- Replacing concrete approach slabs
- Paving the roadway with asphalt on both sides of the structure
- Completing work to improve drainage adjacent to the bridge
- Replacing guardrail on the west side of US 63
- Replacing pavement markings

The WisDOT cultural resources team has determined that this project is unlikely to affect any cultural resources (historical or archaeological).

Proposed Traffic Impacts

US 63 will remain open to traffic during construction operations though staged construction. During the first stage, a single-lane of traffic controlled by temporary traffic signals will be open to traffic. During the second, two lanes of traffic – one in each direction – will be open.

Real Estate

No real estate impacts are anticipated.

Project Schedule

Public comment period: Feb. 5-19, 2025

Final plan submittal: Feb. 1, 2027

Project bid solicitation: Sept. 14, 2027

Construction: 2028

Public Input

We encourage you to talk to the project representatives and ask them questions. Attached to this handout is a sheet for your written comments and input regarding the proposed project. Please mail any written comments about the project by **Feb. 19, 2025**, or leave them in the comment box tonight. In addition, you also can email comments to the project staff listed below.

Project Contacts

Heath Hagner, P.E.

WisDOT Northwest Region Consultant Project Manager

(920) 434-2128

Heath.Hagner@ISGInc.com

Robert Hanold, P.E.

Consultant Project Manager

(608) 588-7484

robert.hanold@jewellassoc.com

Dave Koepp, P.E.

WisDOT Northwest Region Project Supervisor

(715) 563-8402

david.koepp@dot.wi.gov

R-13-W

R-12-W

R-11-W

R-10-W

Town of Wascott

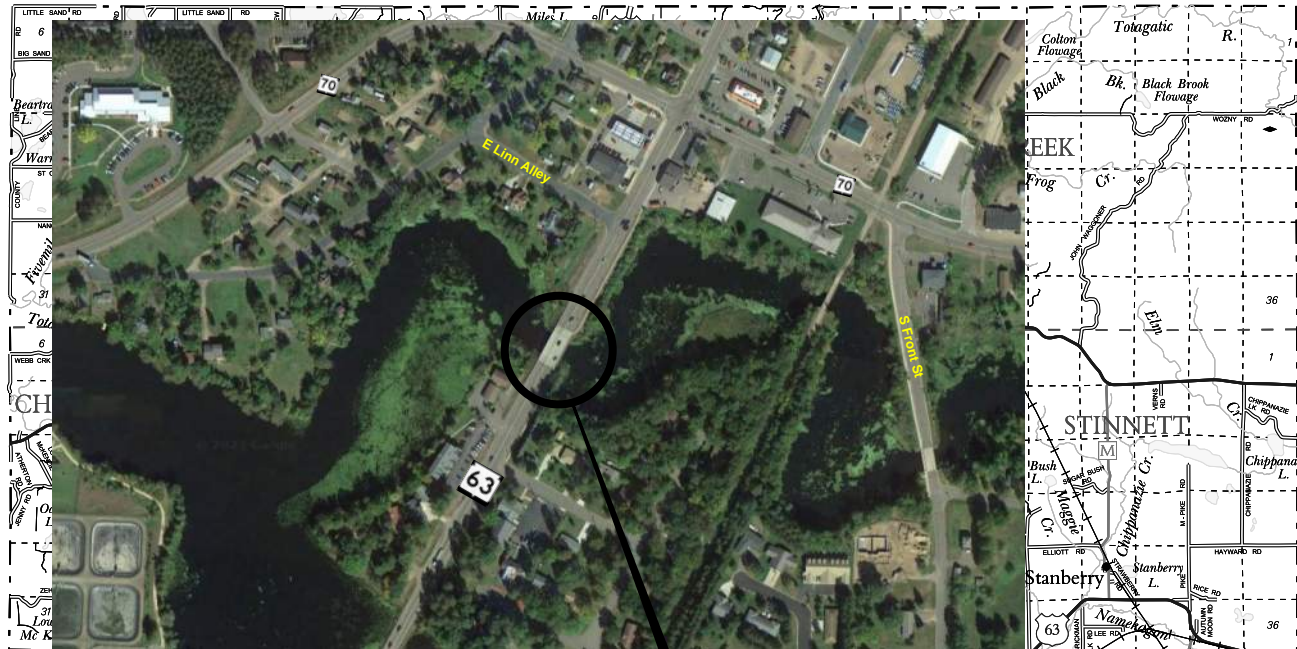

Town of Lemroot

T-42-N

CIVIL TOWNS

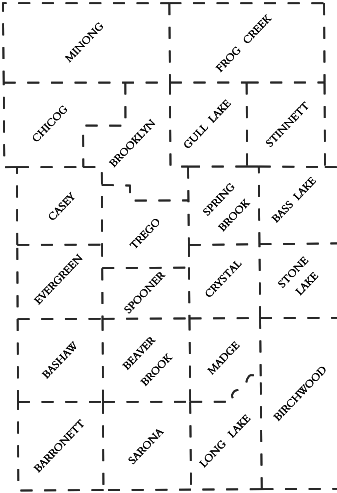

T-42-N

BURNETT CO.

T-41-N

46° 00'

T-40-N

T-39-N

T-38-N

T-37-N

BARRON CO.

R-13-W

R-12-W

R-11-W

R-10-W

Town of Lakeland

Town of Bear Lake

Town of Oak Grove

Town of Cedar Lake

BARRON CO.

PROJECT LOCATION
PROJECT I.D. 1550-04-14
CUMBERLAND - SPOONER
YELLOW RIVER BRIDGE B-65-0014
USH 63
WASHBURN COUNTY

LEGEND

- Freeway -----
- Multilane Divided -----
- U.S. or State Hwy -----
- County Trunk Hwy -----
- Town Road -----
- Firelane -----
- Railroad -----
- State Trail -----
- Interchange -----
- Highway Separation -----
- Interstate Highway No. ----- (94)
- U.S. Highway No. ----- (18)
- State Highway No. ----- (59)
- County Highway Letter ----- (T)
- State Boundary -----
- County Boundary -----
- Civil Town Boundary -----
- Section Line -----
- Dam -----
- Hospital -----
- Airport -----
- County Seat -----
- Unincorporated Village -----
- Fish Hatchery -----
- Game Farm -----
- Public Hunt. or Fish. Grds. -----
- Public Camp & Picnic Grds. -----
- Ranger Station -----
- State Park -----
- County Park ----- With Facilities -----
- Without Facilities -----
- Rest Area ----- Modern Facilities -----
- Wayside ----- Rustic Facilities -----
- Agricultural Research Station ----- (1)

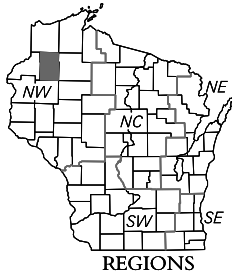

REGIONS

For boundaries of public hunting and fishing grounds please contact the Department of Natural Resources

SECTION NUMBERING OF A TOWNSHIP

6	5	4	3	2	1
7	8	9	10	11	12
18	17	16	15	14	13
19	20	21	22	23	24
30	29	28	27	26	25
31	32	33	34	35	36

MILES OF HIGHWAY

as of Dec. 31, 2019

STATE	137
COUNTY	199
LOCAL ROADS	982
OTHER ROADS	99
TOTAL FOR COUNTY	1417

Land Area (2010 Census) 797 sq mi
 Population (2010 Census) 1591
 County Seat Shell Lake

WASHBURN CO.

DEPARTMENT OF TRANSPORTATION
Madison, Wisconsin

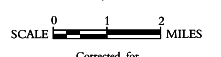

Corrected for
JAN. 2021

Base compiled from U.S.G.S. Quadrangles
1:100,000 Series

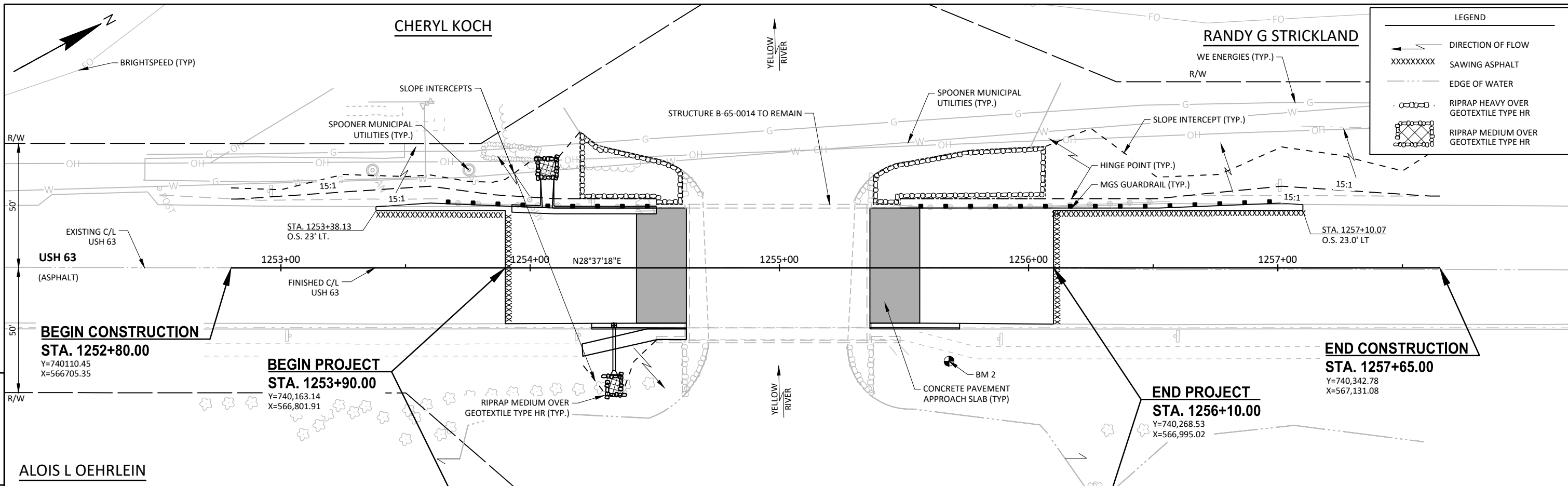

LEGEND	
	DIRECTION OF FLOW
	SAWING ASPHALT
	EDGE OF WATER
	RIPRAP HEAVY OVER GEOTEXTILE TYPE HR
	RIPRAP MEDIUM OVER GEOTEXTILE TYPE HR

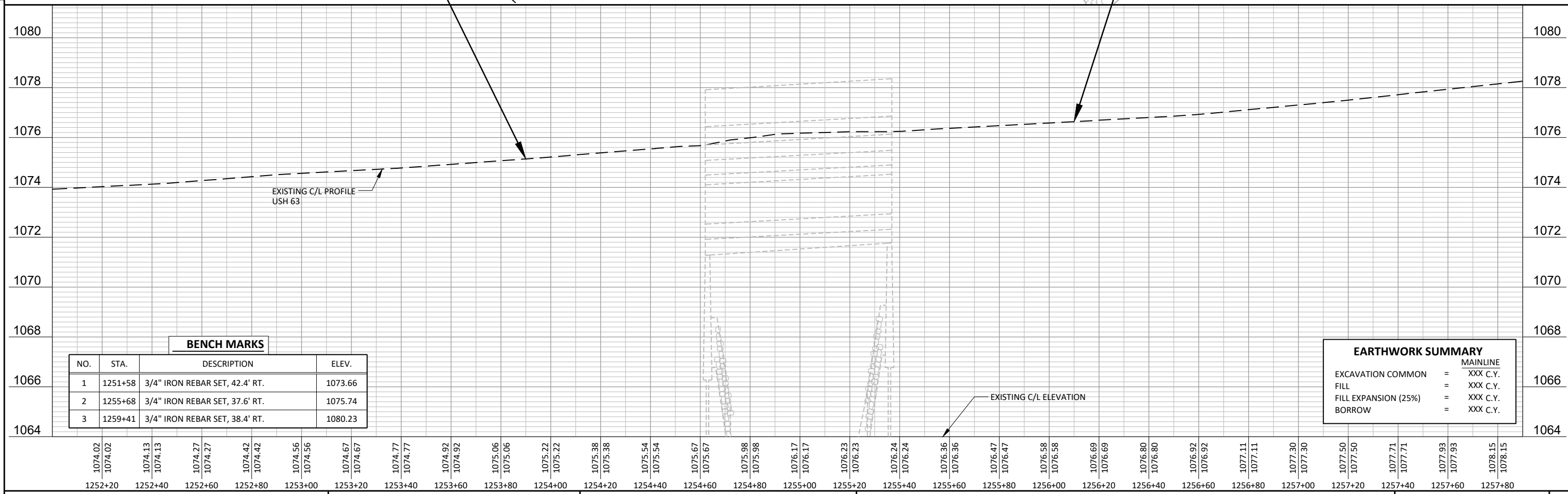

BENCH MARKS			
NO.	STA.	DESCRIPTION	ELEV.
1	1251+58	3/4" IRON REBAR SET, 42.4' RT.	1073.66
2	1255+68	3/4" IRON REBAR SET, 37.6' RT.	1075.74
3	1259+41	3/4" IRON REBAR SET, 38.4' RT.	1080.23

EARTHWORK SUMMARY	
	MAINLINE
EXCAVATION COMMON	= XXX C.Y.
FILL	= XXX C.Y.
FILL EXPANSION (25%)	= XXX C.Y.
BORROW	= XXX C.Y.

PROJECT NO: 1550-04-84 HWY: USH 63 COUNTY: WASHBURN PLAN AND PROFILE: MAINLINE SHEET E

DESIGN DATA

LIVE LOAD:

DESIGN LOADING	HS20
INVENTORY RATING FACTOR	HS 21
OPERATING RATING FACTOR	HS 36
WISCONSIN STANDARD PERMIT VEHICLE (WIS-SPV)	250 KIPS

STRUCTURE IS DESIGNED FOR A FUTURE WEARING SURFACE OF 20 P.S.F.

MATERIAL PROPERTIES:

CONCRETE MASONRY, SUPERSTRUCTURE	$f'_c = 4,000$ P.S.I.
ALL OTHER	$f'_c = 3,500$ P.S.I.
HIGH-STRENGTH BAR STEEL REINFORCEMENT, GRADE 60	$f_y = 60,000$ P.S.I.

TRAFFIC DATA

A.D.T. (2027)	10,430
A.D.T. (2047)	10,430
DESIGN SPEED	25 M.P.H.

GENERAL NOTES

DRAWINGS SHALL NOT BE SCALED.

DIMENSIONS SHOWN ON THE PLANS ARE BASED ON THE ORIGINAL STRUCTURE PLANS, INSPECTION REPORTS, AND FIELD SURVEY.

EXISTING CONCRETE DECK OVERLAY SHALL BE REMOVED FROM THE ENTIRE BRIDGE DECK UNDER BID ITEM "REMOVE CONCRETE MASONRY DECK OVERLAY".

ESTIMATED EXISTING OVERLAY THICKNESS VARIES FROM 1.5" AT CURBS TO 2.94" AT THE C/L. AFTER REMOVAL, REMAINING ORIGINAL DECK THICKNESS IS EXPECTED TO BE 6.5" THROUGHOUT WITH AN EXISTING CROSS SLOPE OF 1.5%. THE FINISHED CROSS SLOPE IS 2.0%. EXPECTED FINISHED AVERAGE OVERLAY THICKNESS IS 2.25" WITH A MINIMUM OF 1.5" AT CURBS AND A MAXIMUM OF 2.5" AT THE C/L. IF THE AVERAGE OVERLAY THICKNESS OR MAXIMUM OVERLAY THICKNESS IS EXCEEDED BY MORE THAN 0.5, CONTACT THE STRUCTURE DESIGN SECTION.

CONCRETE SURFACE REPAIR IS LOCATED AT SIDEWALK AND PARAPET WALLS. AREAS PROVIDED ARE APPROXIMATE. LOCATIONS AND EXTENTS SHALL BE DETERMINED BY THE FIELD ENGINEER.

ALL CONCRETE REMOVAL NOT COVERED WITH A CONCRETE OVERLAY SHALL BE DEFINED BY A 1/2" DEEP SAWCUT.

BAR STEEL REINFORCEMENT SHALL BE EMBEDDED 2" CLEAR UNLESS OTHERWISE SHOWN OR NOTED.

APPLY PROTECTIVE SURFACE TREATMENT TO THE ENTIRE TOP SURFACE OF THE NEW CONCRETE OVERLAY.

PREPARATION DECKS TYPE 1, PREPARATION DECKS TYPE 2, AND FULL-DEPTH DECK REPAIR AREAS ARE BASED ON THE PLANS AND AS DETERMINED BY THE ENGINEER. DECK PREPARATION AND FULL-DEPTH DECK REPAIRS SHALL BE FILLED WITH "CONCRETE MASONRY OVERLAY DECKS".

SEAL OVERLAY CONSTRUCTION JOINTS ACCORDING TO SECTION 502.3.13.1 OF THE STANDARD SPECIFICATIONS. COST INCIDENTAL TO BID ITEM "CONCRETE MASONRY OVERLAY DECKS".

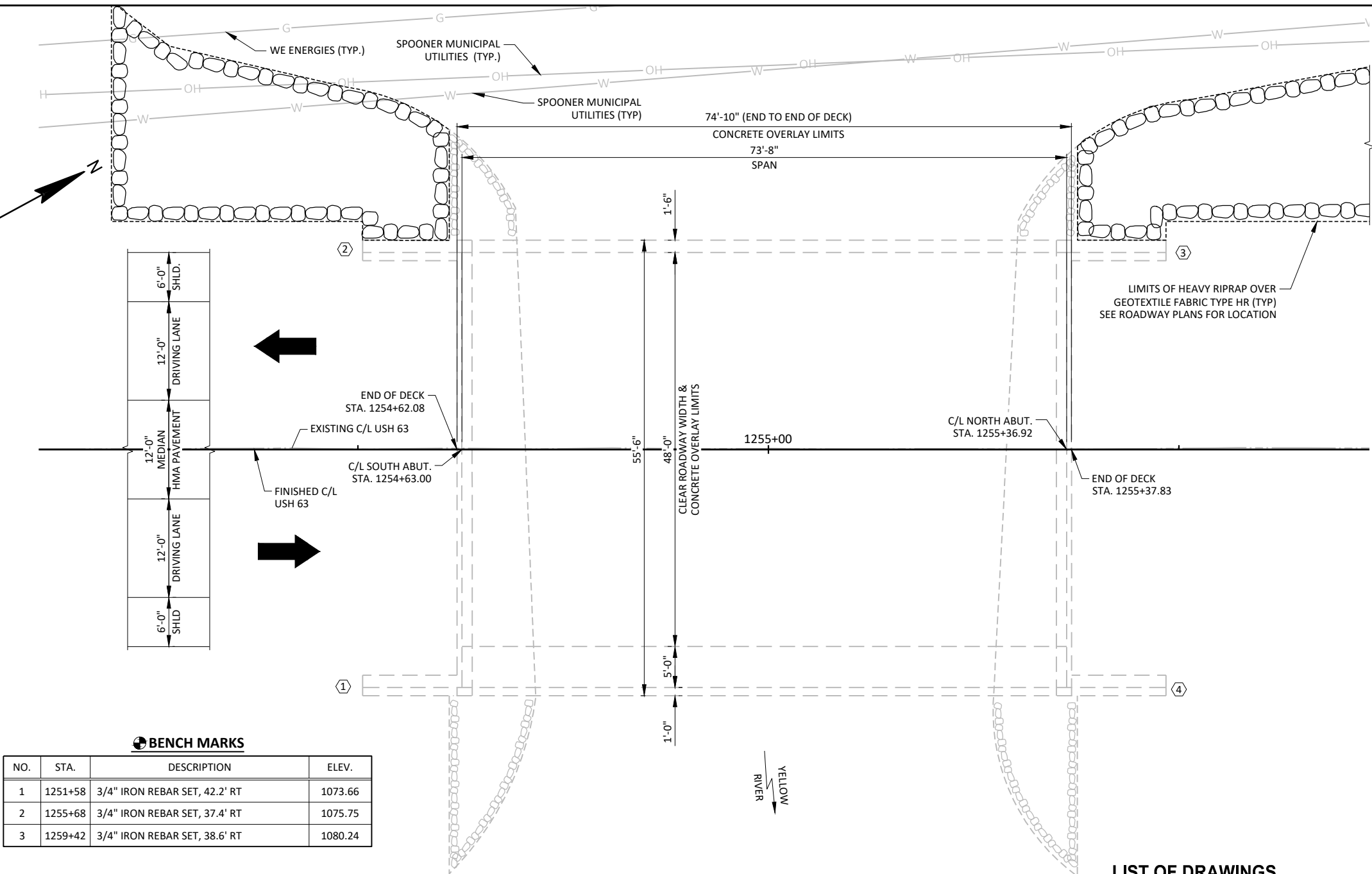

BENCH MARKS

NO.	STA.	DESCRIPTION	ELEV.
1	1251+58	3/4" IRON REBAR SET, 42.2' RT	1073.66
2	1255+68	3/4" IRON REBAR SET, 37.4' RT	1075.75
3	1259+42	3/4" IRON REBAR SET, 38.6' RT	1080.24

PLAN 8-STRUCTURE

(SINGLE-SPAN 36-INCH PRESTRESSED CONCRETE GIRDER STRUCTURE)

○ INDICATES WING NUMBER

LIST OF DRAWINGS

GENERAL PLAN	1.
CROSS SECTION AND QUANTITIES	2.

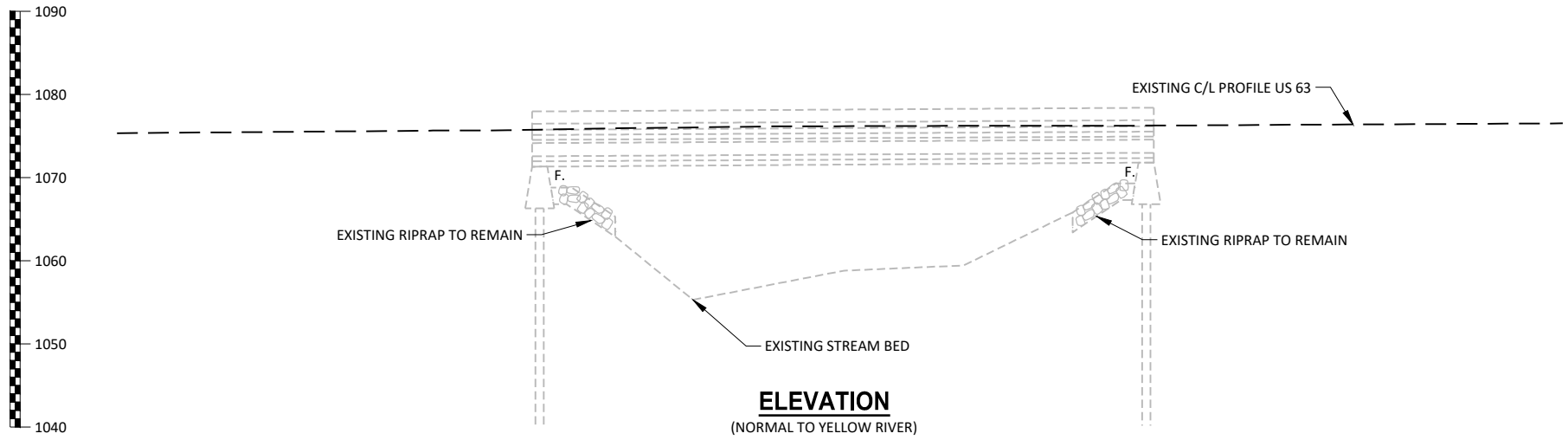

ELEVATION

(NORMAL TO YELLOW RIVER)

DESIGN CONSULTANT
PATRICK BOLAND, PE
(608) 588-7484

BRIDGE OFFICE CONTACT
AARON BONK, PE
(608) 261-0261

NO.	DATE	REVISION	BY
 560 SUNRISE DRIVE SPRING GREEN, WI 53588 OFFICE: (608) 588-7484 www.JewellAssoc.com			
STATE OF WISCONSIN DEPARTMENT OF TRANSPORTATION			
ACCEPTED		DATE	
CHIEF STRUCTURES DESIGN ENGINEER			
STRUCTURE B-65-0014			
USH 63 OVER YELLOW RIVER			
COUNTY	WASHBURN	TOWNSHIP/CITY/VILLAGE	SPOONER
DESIGN SPEC.	AASHTO LRFD BRIDGE DESIGN SPECIFICATIONS		
DESIGNED BY	DESIGN CK'D.	DRAWN BY	MAN CK'D. PTB
GENERAL PLAN			SHEET 1 OF 2

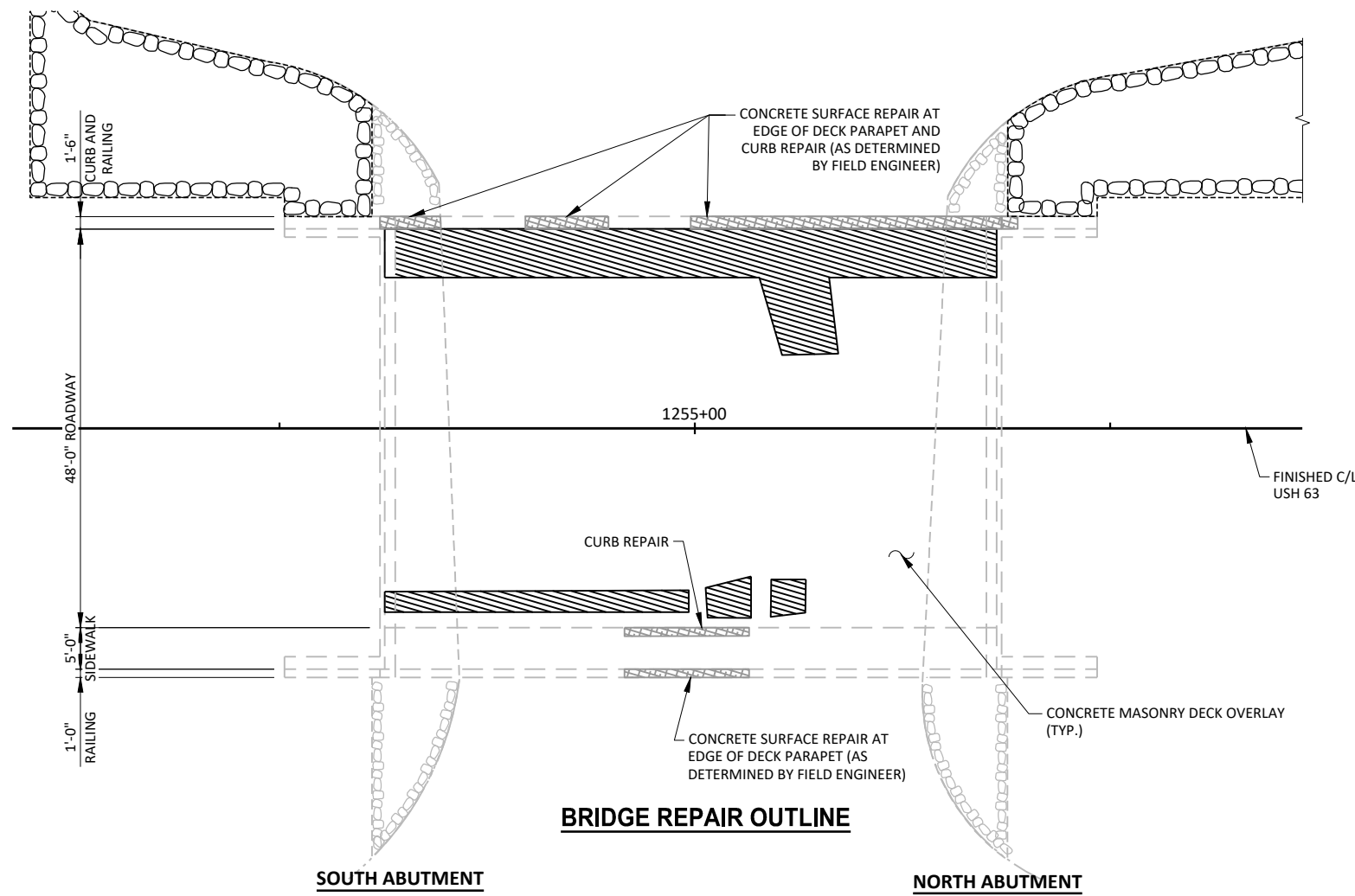

ESTIMATED EXISTING OVERLAY THICKNESS VARIES FROM 1.5" AT CURBS TO 2.94" AT THE C/L. AFTER REMOVAL, REMAINING ORIGINAL DECK THICKNESS IS EXPECTED TO BE 6.5" THROUGHOUT WITH AN EXISTING CROSS SLOPE OF 1.5%. THE FINISHED CROSS SLOPE IS 2.0%. EXPECTED FINISHED AVERAGE OVERLAY THICKNESS IS 2.25" WITH A MINIMUM OF 1.5" AT CURBS AND A MAXIMUM OF 2.5" AT THE C/L. IF THE AVERAGE OVERLAY THICKNESS OR MAXIMUM OVERLAY THICKNESS IS EXCEEDED BY MORE THAN 0.5", CONTACT THE STRUCTURE DESIGN SECTION.

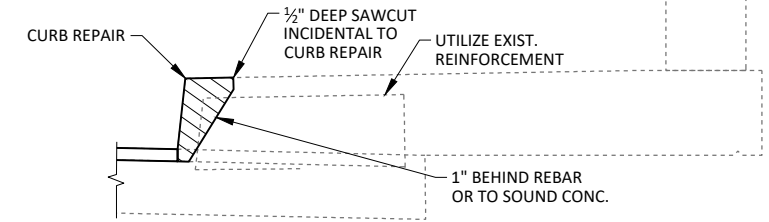

CURB REPAIR DETAIL

DECK REPAIR AREAS

ITEM	UNIT	QUANTITY	%	LEGEND
TOTAL AREA	SY	455	100	DECK PREPARATION AREA
DELAMINATED AREA	SY	71	15.6	CONCRETE SURFACE REPAIR
DECK PREPARATION TYPE 1	SY	71	15.6	
DECK PREPARATION TYPE 2	SY	13	2.8	
FULL DEPTH DECK REPAIR	SY	0	0	

NOTES:
 DECK INSPECTION AND DECK REPAIR AREAS SHOWN ARE FOR REFERENCE ONLY. ENGINEER IN THE FIELD TO VERIFY REPAIR AREAS. DECK REPAIRS SHALL BE MADE ONLY AS DIRECTED BY THE ENGINEER IN THE FIELD.

TOTAL ESTIMATED QUANTITIES

ITEM NUMBER	ITEM DESCRIPTION	UNIT	TOTALS
502.3200	PROTECTIVE SURFACE TREATMENT	SY	--
502.3200	PROTECTIVE SURFACE TREATMENT	SY	--
509.0301	PREPARATION DECKS TYPE 1	SY	--
509.0302	PREPARATION DECKS TYPE 2	SY	--
509.0500	CLEANING DECKS	SY	--
509.1200	CURB REPAIR	LF	--
509.1500	CONCRETE SURFACE REPAIR	SF	--
509.2000	FULL DEPTH DECK REPAIR	SY	--
509.2500*	CONCRETE MASONRY OVERLAY DECKS	CY	--
509.9005.S	REMOVE CONCRETE MASONRY DECK OVERLAY (B-65-0014)	SY	--

* QUANTITY INCLUDES CONCRETE OVERLAY, PREPARATION DECKS TYPE 1, PREPARATION DECKS TYPE 2, FULL DEPTH DECK REPAIR AND CURB REPAIR

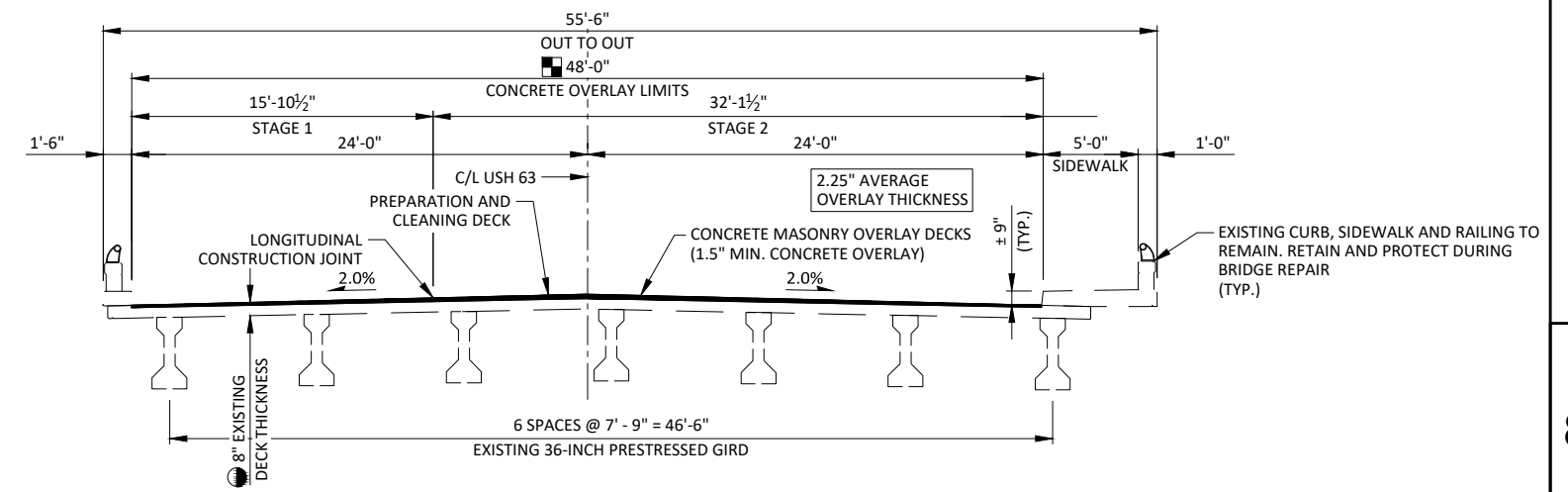

CROSS SECTION THROUGH ROADWAY
(LOOKING NORTH)

NO.	DATE	REVISION	BY
STATE OF WISCONSIN DEPARTMENT OF TRANSPORTATION			
STRUCTURE B-65-0014			
DRAWN BY		MAN	PLANS CK'D. PTB
CROSS SECTION AND QUANTITIES			SHEET 2 OF 2

Fold here

[Stamp]

Wisconsin Department of Transportation

718 W. Clairemont Ave.

Eau Claire, WI 54701

Attn.: Christena O'Brien

Fold here to mail